

## USER MANUAL

Congratulations on purchasing **Soyntec® Powem™ 250 Traveller, Laptop Surge Protection.**

The surge protector **Powem™ 250** is the ideal device for all travellers: compact, practical and versatile.

Protect your laptop/devices against overcharge and power surges coming from the AC power line.

The 2 built-in USB charging ports can charge various types of devices like MP3/MP4, digital cameras, PDA's and many other devices that supports USB charging. The charger also protects against over voltage the USB devices until DC10V (total).

## **1. PROTECTED SCHUKO OUTLETS**

- Protect your laptop/devices against overcharge and power surges.
- 2 Schuko protected outlets
- Children protected outlets.
- Response Time: 1 nano second.
- Electrical rating: 250V / 10A.
- Maximum energy dissipation: 380 Joules.
- Maximum spikes current: 6.500 A.
- Maximum spikes voltage: 6.000 V.

\* To use Powem™ 250 connect it to a free wall outlet.

\* Connect your laptop or any other device in one of the surge protector two outlets.

\* When the device is connected, the laptop or the device is protected against overcharge and power surges.

## **2. 2 BUILT-IN USB CHARGING PORTS:**

- Input: AC 125V~250V, 0.2A.
- Output: DC 5V, 500mAh per USB port.
- USB Over voltage protection: DC 10V.

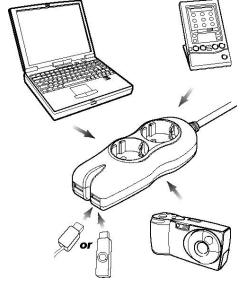

- \* How to use: Make sure **Powem™ 250** is connected to a wall outlet before starting to use the USB charger.
- \* Check the USB connector type. Just use standard USB connectors of the same type and size as **Powem™ 250** USB charger ports.
- \* Please connect your device to one of the free USB ports (cable not included).
- \* You can use both USB charging ports simultaneously, always respecting the maximum charging amperage allowed of 1.0A.

\* Disconnect the device from **Powem™ 250** USB ports when the recharging is finished.

**IMPORTANT NOTE:**

PLEASE ALWAYS CHECK THE AMPERAGE INPUT OF YOUR DEVICE BEFORE STARTING TO CHARGE IT.

IF THE DEVICE HAVE AN INPUT AMPERAGE BELOW 500mAh IT COULD GET SERIOUSLY DAMAGED, AND IF IT HAVE AN AMPERAGE SUPERIOR THAN 500mAh IT COULD NOT BE CHARGED PROPERLY.

### 3. SAFETY

- Do not use **Powem™ 250** near water or in a humid environment. Only use it in dry conditions and indoor.
- Do not use this device if the plug, the cable or any other part of it is damaged, broken or if any liquid has entered the device.
- Only connect this device to an earthed plug socket.
- Never overload this device to its maximum voltage/ampereage (10A). The overloading of this product will result in the cancellation of the warranty.
- Before connecting the rechargeable devices to the USB charger, make sure there are no foreign objects inside the USB ports.
- Never force a connector into the **Powem™ 250** USB charger input if the connectors aren't compatible.

## **WARRANTY**

**Soyntec** warrants its products to be free from defects in materials and workmanship at the time of purchase.

**The warranty period is 36 months** from the date of purchase for MP3 Players, Digital Cameras, Speakers, Keyboards, Mouses, Webcams, Voice over IP, PC headsets, USB Connectivity, Game controls, UPS (except for U.P.S. batteries, which have a warranty period of 24 months). In the case of Surge protection, the warranty period is **60 months**.

## **WARRANTY PROCEDURE**

1) Visit the Support section at <http://support.soyntec.com> and select your product to view the FAQ (Frequently Asked Questions). The solution to your problem is very likely to have been already published there. You will also be able to download user manuals, user guides, drivers and updates.

2) If you cannot find an appropriate solution in the Support section, you may send us your enquiry or warranty service request by email: [support@soyntec.co.uk](mailto:support@soyntec.co.uk)

3) Alternatively, you may prefer to contact the distributor from which you purchased the product, presenting them with the receipt or invoice.